

THE GLENSHEE



3 Bedroom Detached Bungalow

The Glenshee is a three bedroom bungalow offering spacious living, making it an ideal choice for those looking for the flexibility that comes with living on one level.

The front door opens into the entrance hallway with double doors leading into the living room having dual aspect views, and French doors that lead into the rear garden. The dining kitchen boasts an airy feel with its modern units and dual aspect views whilst the laundry room gives access to the rear door into the garden.

Follow down the hallway to the master bedroom with its bay window and En-suite, along with two further generous sized bedrooms and family bathroom that includes bath and separate shower cubicle.

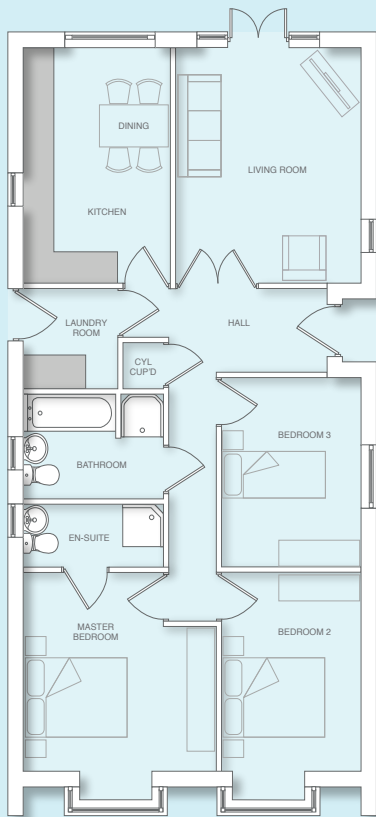

Ground Floor

Living Room	4500	x	3635	mm
	14' 9"	x	11' 11"	
Kitchen Dining	4500	x	2885	mm
	14' 9"	x	9' 5"	
Laundry Room	1920	x	1853	mm
	6' 3"	x	6' 6"	
Master Bedroom	3800	x	3780	mm
	12' 5"	x	12' 4"	
En-Suite	1200	x	2750	mm
	3' 11"	x	9' 0"	
Bedroom 2	3800	x	2740	mm
	12' 5"	x	8' 11"	
Bedroom 3	3620	x	2740	mm
	11' 10"	x	8' 11"	
Bathroom	2000	x	2750	mm
	6' 6"	x	9' 0"	



www.broadgatehomes.com

This image is from an imaginary viewpoint within an open space area. Its purpose is to give a feel for the development, not an accurate description of an individual property. It shows a typical Broadgate home of this type, but external materials and landscaping may vary throughout the development and from site to site. Certain windows are subject to plot position on site. Properties may also be built handed (mirror image).

The floor plans depict a typical layout of this housetype. All dimensions are + or - 50mm and floor plans are not shown to scale. For exact plot specification, details of external and internal finishes, dimensions and floor plan differences always consult your Sales Negotiator. AV19/988/GS

