

SIGNATURE  
COLLECTION

Apartment S05

An outstanding penthouse apartment with triple-tier terrace and its own Tower Room turret

Fabulous outdoor space is the centrepiece of this superb three bedroom penthouse apartment. Accessed from the living space, there are no less than three terraced areas on different levels, encompassing beautiful original chimney features. From here, enjoy looking out over the iconic Donaldson's domes and turrets, or enter your own exclusive Tower Room turret. Indoors, original beams feature in the bright, open plan kitchen, dining and living space and bedrooms. The spacious master suite is bathed in light through Velux windows and features a dressing area and fantastic en suite with tear drop bath and separate shower. This apartment also benefits from an additional space on the mezzanine floor - ideal for use as a snug, cinema room or office.

Dimensions

Total NSA 2665 sq ft (247.6 sq m)

|                  |                 |                 |
|------------------|-----------------|-----------------|
| Living           | 31' 1" x 17' 5" | (9.48m x 5.31m) |
| Kitchen / Dining | 24' 3" x 16' 5" | (7.39m x 5.00m) |
| Master Bedroom   | 15' 0" x 13' 5" | (4.58m x 4.09m) |
| Bedroom 2        | 14' 8" x 13' 5" | (4.46m x 4.09m) |
| Bedroom 3        | 16' 8" x 12' 6" | (5.07m x 3.82m) |
| Cinema Room      | 23' 9" x 8' 5"  | (7.29m x 2.62m) |

THE  
PLAYFAIR

AT DONALDSON'S

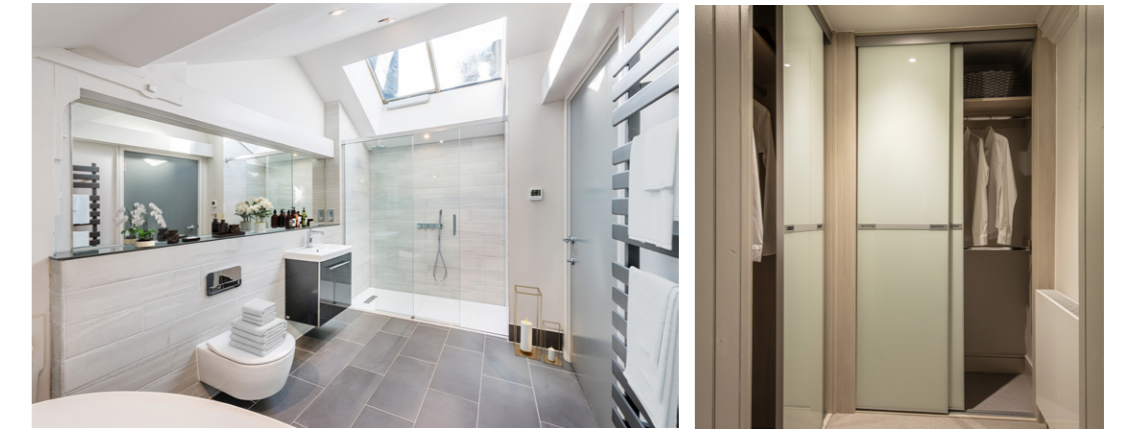
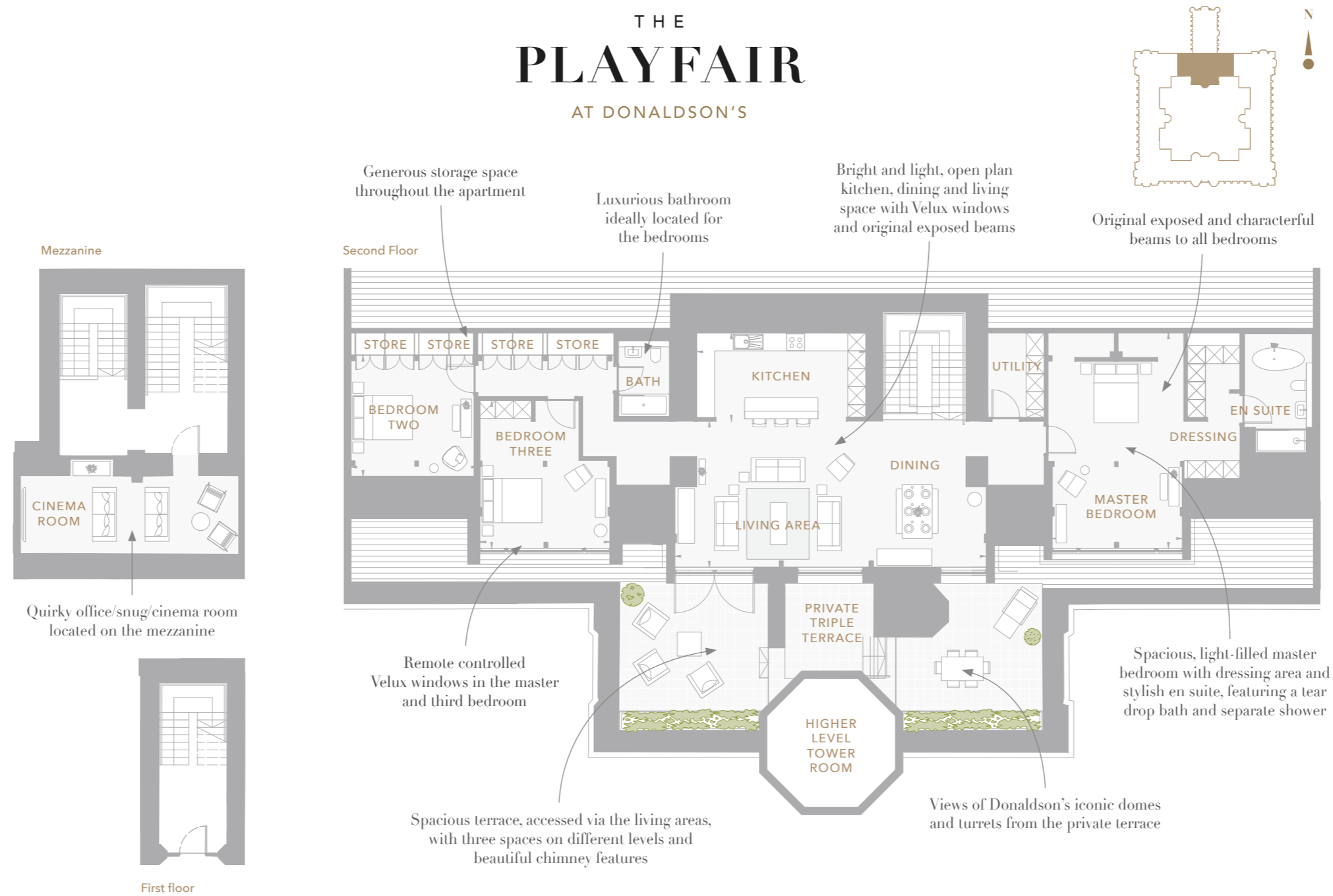

Photography shown is a mixture of computer enhanced images and similar apartments at Donaldson's and is for illustrative purposes only.