

# THE TWEED

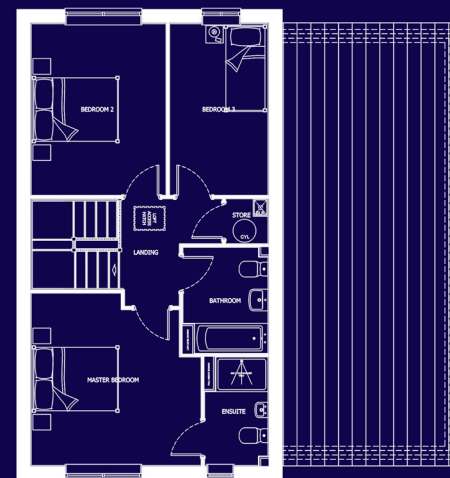
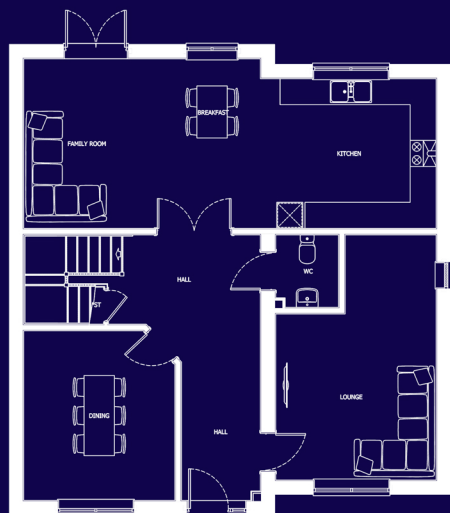

A Three bedroom home, perfect for families and first-time buyers

|         |             |             |
|---------|-------------|-------------|
| LOUNGE  | 5.7 X 3.74  | 18'9 X 12'4 |
| KITCHEN | 3.5 X 4.0   | 11'6 X 13'4 |
| WC      | 1.7 X 1.2   | 5'8 X 3'11  |
| DINING  | 3.96 X 3.53 | 13' X 11'7  |
| FAMILY  | 3.9 X 5.5   | 13' X 18'1  |
| STORE   | 0.89 X 0.6  | 5'8 X 3'11  |

|           |           |             |
|-----------|-----------|-------------|
| M BEDROOM | 4.0 X 3.9 | 13'2 X 11'3 |
| ENSUITE   | 2.5 X 4.1 | 8'4 X 4'1   |
| BATHROOM  | 2.4 X 2.0 | 8'2 X 6'7   |
| STORE     | 1.0 X 1.0 | 3'4 X 3'4   |
| BEDROOM 2 | 3.9 X 3.1 | 13' X 10'4  |
| BEDROOM 3 | 3.9 X 2.3 | 13' X 7'7   |



Please refer to your site map for plot numbers for this housetype. These dimensions are correct to within 50mm/2" but should not be used as a basis for the purchase of furnishings. Individual properties may vary from illustrations shown.