

ANWYL
thoughtful homes



the whitworth

5 bed detached with garage

The five-bedroom Whitworth raises the bar, delivering quality without compromise over three floors. Spanning the entire second floor is the *boutique* premier bedroom suite, with a bath and a double shower, plus twin sinks. When it comes to exceptional executive living, The Whitworth is without equal, providing the highest standards on every level.

www.anwylhomes.co.uk

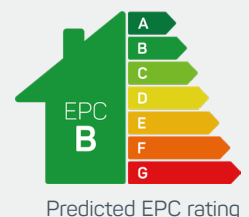



modern
open plan living

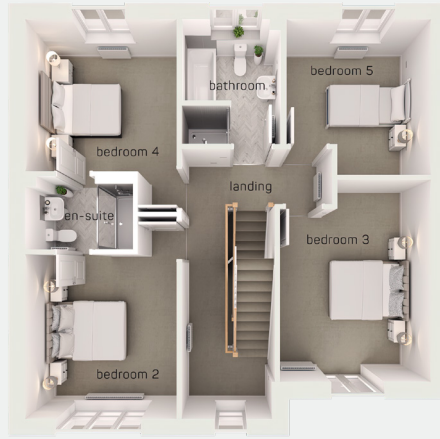

ground floor

kitchen/dining/family	28'2" x 10'10"
living room	10'5" x 16'5"
utility	6'0" x 5'8"
cloaks	6'9" x 4'0"

kitchen/dining/family	8.57m x 3.30m
living room	3.17m x 5.01m
utility	1.82m x 1.72m
cloaks	2.06m x 1.22m

first floor

bedroom 2	10'5" x 14'1"
en-suite	7'6" x 5'1"
bedroom 3	10'6" x 14'1"
bedroom 4	10'5" x 13'4"
bedroom 5	10'0" x 10'9"
bathroom	6'10" x 8'8"

bedroom 2	3.17m x 4.29m
en-suite	2.27m x 1.55m
bedroom 3	3.19m x 4.29m
bedroom 4	3.17m x 4.07m
bedroom 5	3.05m x 3.29m
bathroom	2.08m x 2.63m

second floor

bedroom 1	17'4" x 22'9"
en-suite	10'6" x 10'7"

bedroom 1	5.29m x 6.93m
en-suite	3.19m x 3.22m

the whitworth
5 bed detached with garage

ANWYL
thoughtful homes

NEW HOMES QUALITY CODE

NEW HOMES OMBUDSMAN SERVICE

www.anwylhomes.co.uk

Anwyl Homes is a Registered Developer with the NHQB. This is a computer-generated image of the whitworth, elevation treatment may vary. Room sizes are approximate, dimensions are taken from the longest room point (please consult homes advisor for measurement points). Plots may be handed and any garages may be single or double. Kitchen and bathroom layouts are indicative. These plans are correct at the time of going to press, but may be subject to change during construction. Please ensure that you check for specific plot details. 13/11/23.

everything considered.