

# The Langdon

Four bedroom detached home

Plots 89\*, 91\*, 93, 429 & 432\*  
Gross Internal Area: 158.7 sq m (1,708 sq ft)



**Key:**

C - Cupboard W - Built-in Wardrobe ▲ - Front Entrance ◀▶ - Depicts where measurements have been taken from

\* Denotes handed plot. Individual plots vary in size, please ask the Sales Consultant for details.



**First Floor**

- Principal Bedroom**  
5.88m x 3.49m 19' 3" x 11' 5"
- Bedroom 2**  
4.42m x 3.69m 14' 6" x 12' 1"
- Bedroom 3**  
4.83m x 2.74m 15' 10" x 9' 0"
- Bedroom 4**  
3.49m x 3.38m 11' 5" x 11' 1"

\*\* Window to plots 91, 93 & 429 only

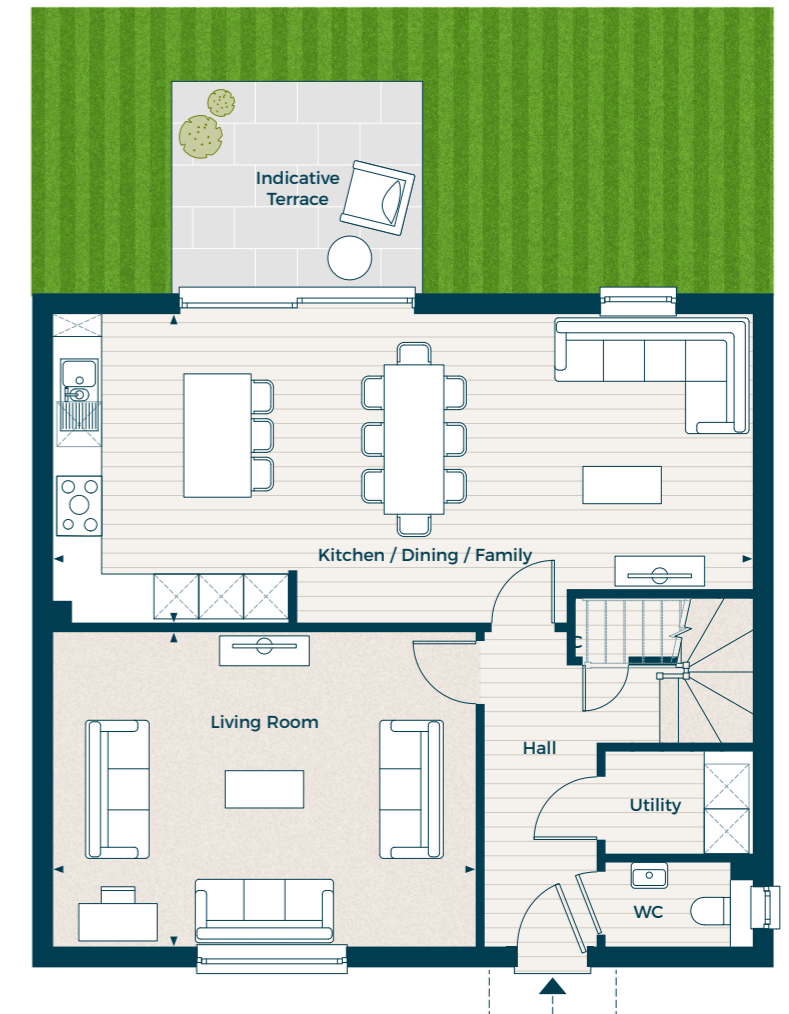

**Ground Floor**

- Living Room**  
5.66m x 4.21m 18' 7" x 13' 10"
- Kitchen / Dining / Family**  
9.37m x 4.13m 30' 9" x 13' 7"

\*\* Window to plots 91, 93, 429 & 432 only

Computer generated images are indicative only. Floor plans shown are indicative only. To increase legibility these plans have been sized to fit the page and as a result may be of a different scale to others within this document. Location of windows, doors, wardrobes, kitchen units, appliance spaces and bathroom fittings may differ. Garden and Terrace is indicative only. All measurements may vary within a tolerance of 5%. The dimensions are not intended to be used for carpet sizes, appliance sizes or items of furniture.