

# Plot.17

3 Bedroom Bungalow



This CGI is an indicative representation of the external finish of this house type on one of the properties on this development. The final appearance of each property may need to be altered during the construction process, particularly when dealing with ground levels. Our sales representative will be happy to discuss the external finish on any specific plot with you.



# Plot.17

3 Bedroom Bungalow

# Hopfield Court

Little Tarrington, Herefordshire, HR1 4JA

ROOM	IMPERIAL / "	METRIC / mm
Living / Kitchen / Dining	20' 3" x 18' 11"	6167 x 5760mm
Bedroom 1	12' 9" x 8' 6"	3882 x 2591mm
Bedroom 2	11' 1" x 8' 6"	3385 x 2591mm
Bedroom 3	9' 11" x 6' 6"	3004 x 1968mm
Bathroom	5' 7" x 10' 1"	1700 x 3081mm

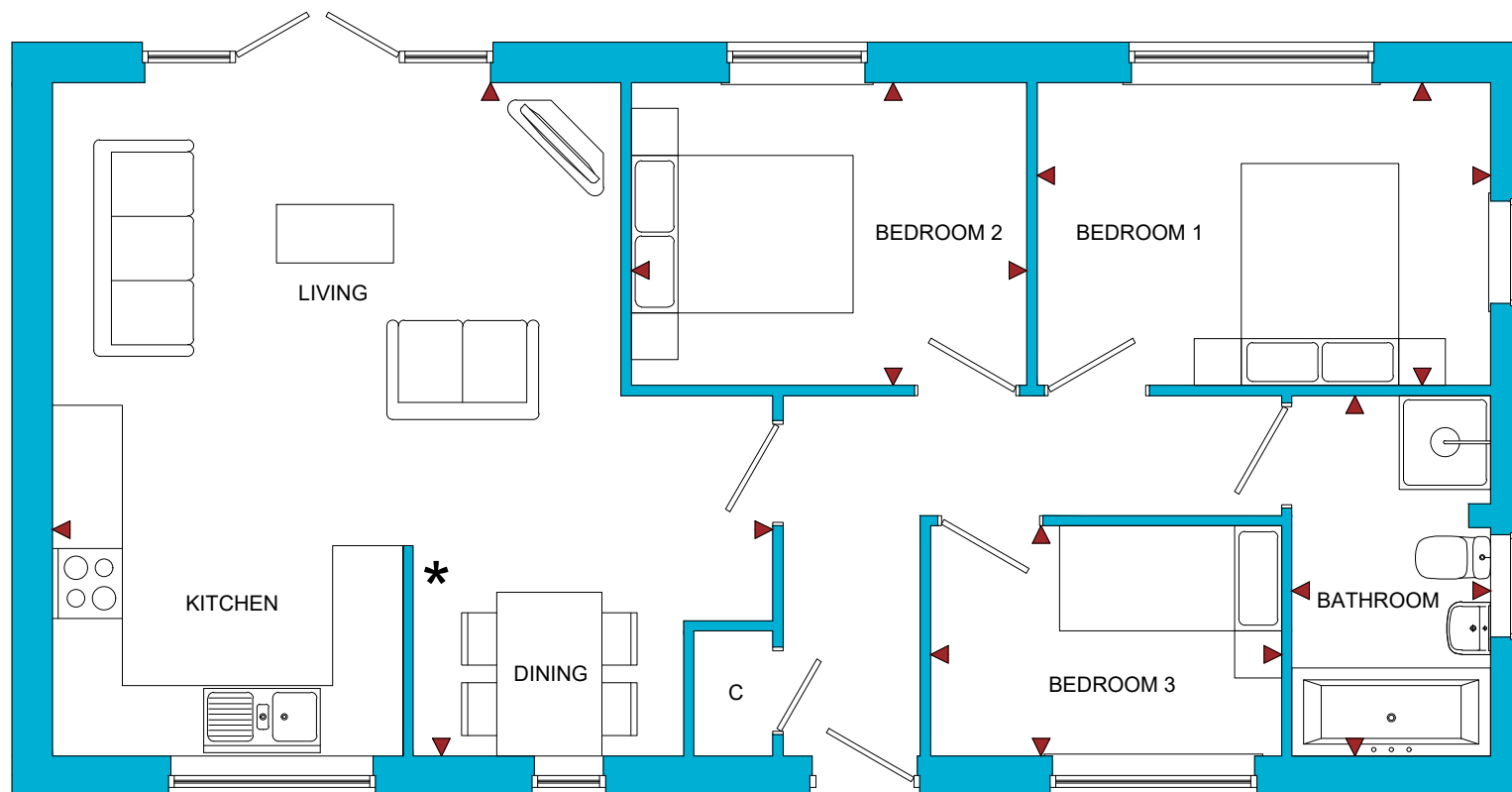

GROUND FLOOR

TOTAL FLOOR AREA  
763ft<sup>2</sup> / 70.9m<sup>2</sup>

\* Low Level Wall

[www.bellhomes.com](http://www.bellhomes.com)

We strive to make each home and development as varied and interesting as possible. Therefore the above is for illustration purposes only and individual properties may vary. Please ask for details of specific properties. Every care has been taken with the preparation of this information, which has been produced for your guidance only and does not form part of a contract. The Plans are NOT TO SCALE, and may vary on site. Please do not use this information for purchase of furnishings and furniture.

**bellhomes**

the name that stands for quality homes

# ***Plot.17***

**3 Bedroom Bungalow**

# ***Hopfield Court***

**Little Tarrington, Herefordshire, HR1 4JA**

## **Key Features/Included Specification**

- Low Cost Home – Subject to Herefordshire Council Criteria
- Choice of Kitchens and Laminate Worktops
- Choice of Wall Tiles to Kitchen and Bathroom
- Choice of Ceramic Floor Tiles to Kitchen and Bathroom
- White Low Energy LED Downlighters to Bathroom
- Built Under Single Oven, 4 Burner Gas Hob & Stainless Steel Chimney Hood
- Wiring for an Alarm System
- Chrome Towel Radiator to Bathroom
- 6 Panel White Doors with Chrome Ironmongery
- Storage Cupboard to Hallway
- Open Plan Kitchen, Living & Dining Area with French Doors to Rear Garden
- Two Double Bedrooms & One Single Bedroom
- Family Bathroom with Separate Shower Cubicle
- Landscaped Front Gardens
- Paved Patio Area
- Off Road Parking
- External Tap

**[www.bellhomes.com](http://www.bellhomes.com)**

We strive to make each home and development as varied and interesting as possible. Therefore the above is for illustration purposes only and individual properties may vary. Please ask for details of specific properties. Every care has been taken with the preparation of this information, which has been produced for your guidance only and does not form part of a contract. The Plans are NOT TO SCALE, and may vary on site. Please do not use this information for purchase of furnishings and furniture.



**bellhomes**

the name that stands for quality homes