

THE YATE

PLOTS 8, 9, 10 & 11



- 2 Bedroom Home
- Separate Kitchen
- Open Plan Living / Dining Room
- Downstairs W/C
- Family Bathroom
- Off-Road Parking
- Energy Efficient Materials Throughout



THE YATE

FLOOR PLAN

| ROOM | IMPERIAL / " | METRIC / mm |
|-----------------|-----------------|---------------|
| Living / Dining | 13' 0" x 13' 9" | 3970 x 4190mm |
| Kitchen | 6' 2" x 11' 1" | 1868 x 3368mm |

| ROOM | IMPERIAL / " | METRIC / mm |
|-----------|----------------|---------------|
| Bedroom 1 | 13' 0" x 9' 7" | 3970 x 2917mm |
| Bedroom 2 | 13' 0" x 8' 6" | 3970 x 2578mm |
| Bathroom | 6' 5" x 6' 6" | 1943 x 1975mm |

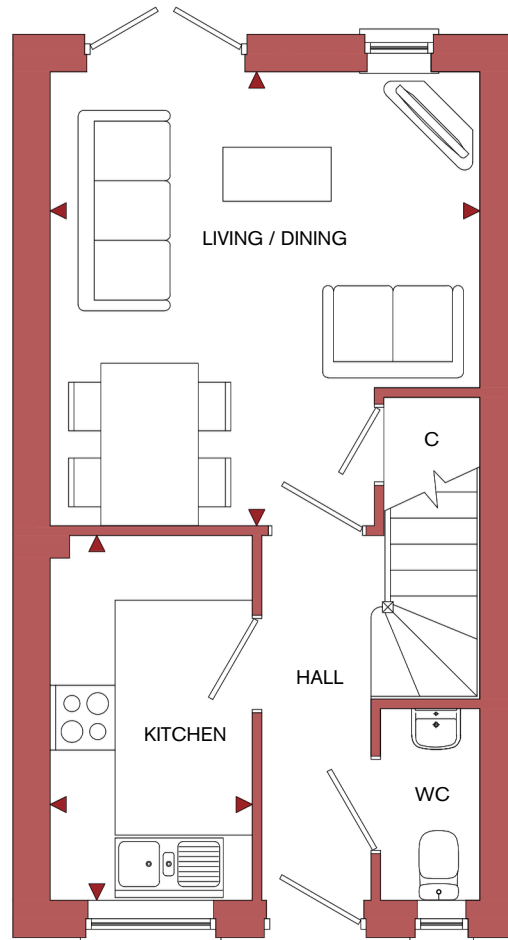

GROUND FLOOR

TOTAL FLOOR AREA
653ft² / 60.7m²

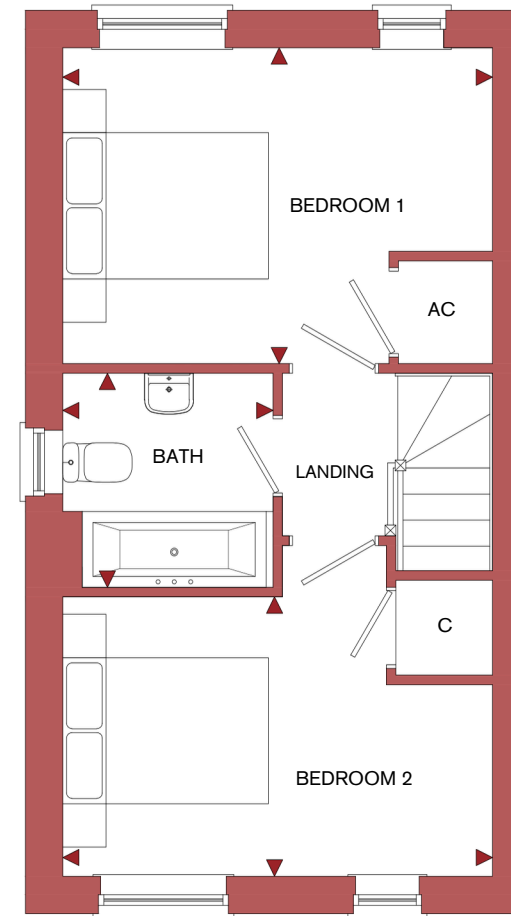

FIRST FLOOR