

ANWYL  
thoughtful homes



## the whitworth

### 5 bed detached with garage

A *spacious* 5 bedroom home delivering quality without compromise over 3 floors. Ideal for families. Key features include an impressive master suite spanning the entire top floor, a Jack and Jill ensuite to bed 2 and 4 as well as a separate family bathroom.

[www.anwylhomes.co.uk](http://www.anwylhomes.co.uk)

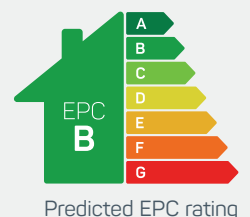



Large open plan  
family space

### ground floor

kitchen/dining/ family	28'2" x 10'10"
living room	10'5" x 16'5"
utility	6'0" x 5'8"
cloaks	6'9" x 4'0"

kitchen/dining/ family	8.57m x 3.30m
living room	3.17m x 5.01m
utility	1.82m x 1.72m
cloaks	2.06m x 1.22m

### first floor

bedroom 2	10'5" x 14'1"
en-suite 2	7'6" x 5'1"
bedroom 3	10'6" x 14'2"
bedroom 4	10'5" x 13'4"
bedroom 5	10'0" x 10'9"
bathroom	6'10" x 8'8"

bedroom 2	3.17m x 4.29m
en-suite 2	2.27m x 1.55m
bedroom 3	3.19m x 4.31m
bedroom 4	3.17m x 4.07m
bedroom 5	3.05m x 3.27m
bathroom	2.08m x 2.63m

### second floor

bedroom 1	17'4" x 22'9"
en-suite 1	10'6" x 10'7"

bedroom 1	5.29m x 6.93m
en-suite 1	3.19m x 3.22m

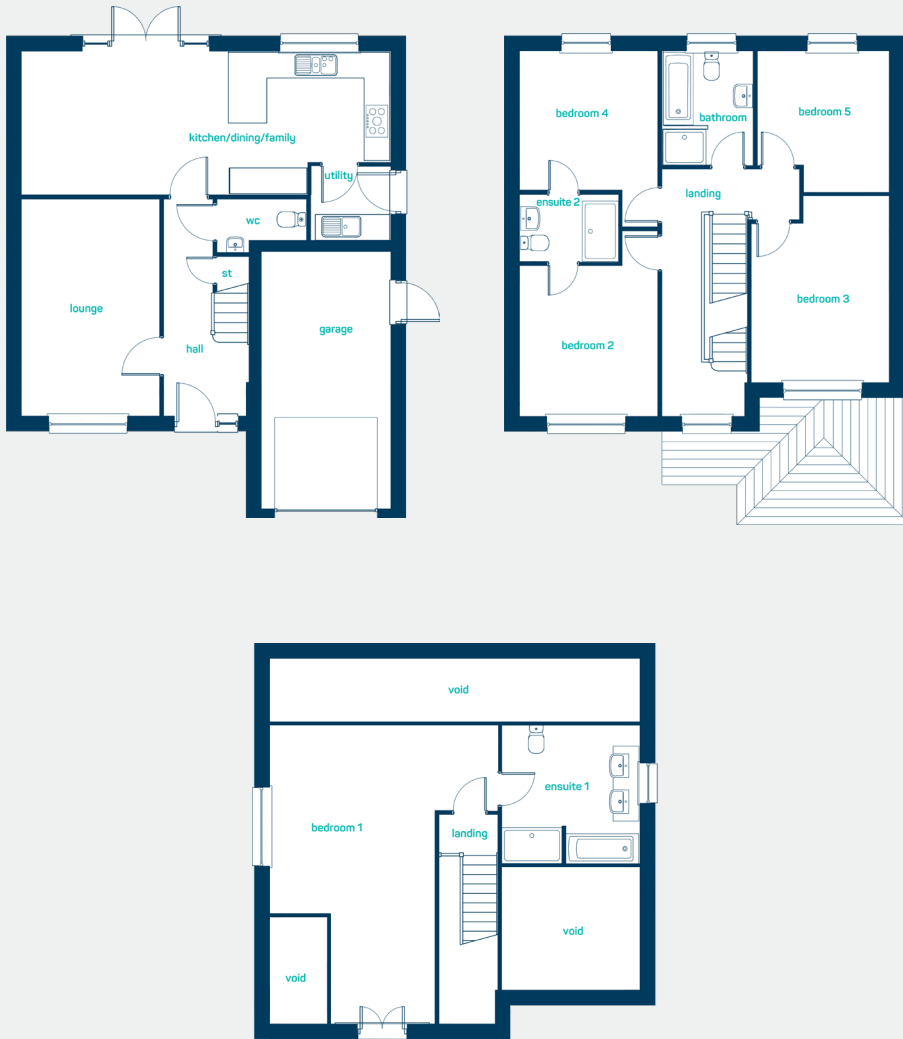

**the whitworth**  
5 bed detached with garage

[www.anwyhomes.co.uk](http://www.anwyhomes.co.uk)

**ANWYL**  
thoughtful homes

**NEW  
HOMES  
QUALITY  
CODE**

**NEW HOMES  
OMBUDESMAN  
SERVICE**

Anwyl Homes is a Registered Developer with the NHQB. This is a computer-generated image of the whitworth, elevation treatment may vary. Room sizes are approximate, dimensions are taken from the longest room point (please consult homes advisor for measurement points). Plots may be handed and any garages may be single or double. Kitchen and bathroom layouts are indicative. These plans are correct at the time of going to press, but may be subject to change during construction. Please ensure that you check for specific plot details. 20/09/23.

*everything considered.*